

# 4K

## A 32-inch widescreen surgical monitor with 4K UHD resolution and high brightness.

### 4K UHD Resolution and High Brightness

The monitor uses an energy-efficient LED backlight with a high brightness of 700 cd/m<sup>2</sup>. The high resolution of 3840 x 2160 is four times the size of full HD and faithfully reproduces 4K endoscope and operating microscope images in high definition.

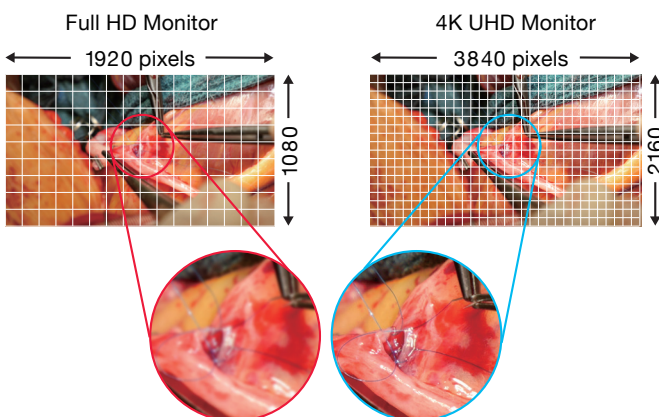

### Safe and Easy Cable Management

With 12G-SDI (BNC), and DisplayPort 1.2 or HDMI, 4K UHD images are displayed at 60 frames per second with a single cable over various modalities. Also, the small AC adapter size aids in easy cable management. With the 12G-SDI (BNC) terminal, stable transmission is possible even over long distances of 30 meters.

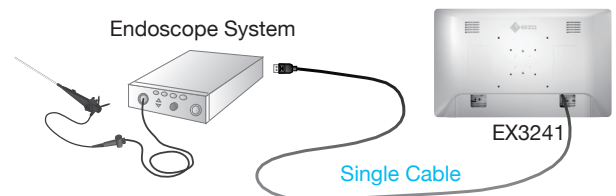

Typically HDMI cables cannot be locked into a terminal but this monitor contains a specialized locking mechanism on its side specifically for HDMI. This ensures all cables can be locked onto the monitor for consistent and stable connection.

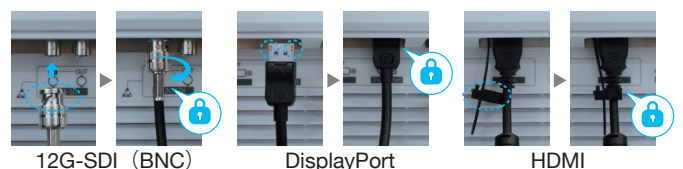

# CuratOR® EX3241

## Enhanced Sharpness

EIZO's proprietary image sharpening technology Smart Resolution with Sparse Coding (S.R.S.C.) allows full HD images shot by conventional endoscopy and surgical cameras to be displayed in high definition 4K resolution without lag.

## View Large Images in Full HD

When inputting a 4K UHD signal, you can zoom in on a specific area of the screen and display it with a resolution equal to or higher than full HD.

## Sharp Color Reproduction with Wide Color Gamut

Not only does the monitor faithfully display the sRGB color gamut, but it also reproduces images emulating the 4K video color standard BT.2020. This ensures vivid reds and yellow-greens captured with BT.2020-supported cameras are displayed more accurately.

## HDR Compatibility

HDR (High Dynamic Range) is a range that approximates the human perception of color and light as content is shown on a display device. The monitor is equipped with the perceptual quantization (PQ) curve and hybrid log-gamma (HLG) for supporting HDR. This ensures images from HDR-supported endoscope cameras are displayed without crushing blacks and more closely resemble the human visual system.

## Fully Flat Design for Safety and Hygiene

Operating rooms contain various medical devices that are arranged by the type of surgery being undertaken. In consideration of safety, EIZO's surgical monitors adopt rounded corners. Furthermore, the front is covered with a fully flat protective glass with IP45 for protection against foreign material and splashes (the whole monitor has an IP32 rating). With the attached cable cover, cables can also be neatly stored out of sight for increased safety and hygiene.

## Reduced Reflections

Reflections on the screen of LCD monitors are caused when external light hits the screen and reflects off of the protective glass and layer of air at different refractive indices. Optical bonding removes the layer of air in order to lower the difference in refractive indices. This softens the reflections on the screen and produces a clear, highly visible image without affecting contrast.

## Preset Functions for Easy Switching

Various settings such as the input terminal selection, brightness, grayscale tones, color gamut, etc. can be stored in the monitor as preset functions. These settings can be named according to the operator's preference by easy operation of the OSD (On Screen Display) button.

## Specifications

Panel	Type	Color (IPS)
	Backlight	LED
	Size	81.3 cm / 32.0"
	Native Resolution	3840 x 2160 (16:9 aspect ratio)
	Viewable Image Size (H x V)	708 x 399 mm
	Pixel Pitch	0.185 x 0.185 mm
	Display Colors	10-bit colors (SDI / DisplayPort / HDMI) : 1.07 billion (maximum) colors 8-bit colors: 16.77 million colors
	Viewing Angles (H / V, typical)	178° / 178°
	Brightness (typical)	700 cd/m <sup>2</sup>
	Contrast Ratio (typical)	1000:1
	Response Time (typical)	18 ms (on / off)
Wide Gamut Coverage (typical)	BT.2020 emulation	
Video Signals	Input Terminals	DisplayPort (HDCP 1.3), HDMI (HDCP 2.2/1.4), BNC (12G-SDI), BNC (3G-SDI), DVI-D x 2 (HDCP 1.4)
	Output Terminals	BNC (12G-SDI), BNC (3G-SDI), DVI-D
	Digital Scanning Frequency (H / V)	27 - 135 kHz / 24 - 60 Hz
USB	Upstream	USB 2.0: Type-B (CDC)
Power	Power Requirements	AC 100 - 240 V: 50 / 60 Hz
	Maximum Power Consumption	188 W
Features & Functions		Remote control (USB, RS-232C)
Physical Specifications	Net Weight (Without Stand)	12.8 kg
	Hole Spacing (VESA Standard)	200 x 200 mm, M6, depth 7 - 11 mm / 100 x 100 mm, M4, depth 7 - 9 mm
Environmental Requirements	Degree of Protection	IP45 (Front), IP32 (Rear)
Certifications & Standards (Please contact the EIZO group company or distributor in your country for the latest information.)		CE (Medical Device Directive), EN60601-1, ANSI/AAMI ES60601-1, CSA C22.2 No. 601-1, IEC60601-1, VCCI-A, FCC-A, CAN ICES-3(A), RCM, RoHS, China RoHS, WEEE, CCC, EAC, BIS
FDA		Class I
Supplied Accessories (May vary by country. Please contact EIZO for details.)		AC power cord, AC adapter, Cable cover, Utility Disk (PDF installation manual), instructions for use
Warranty		Two Years

## Dimensions (Unit: mm)

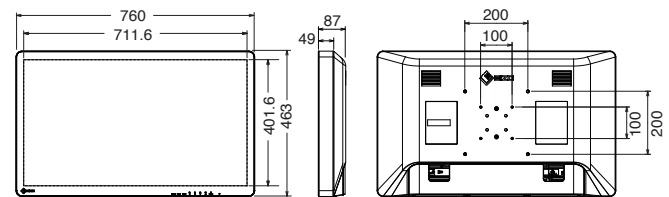

## Connector

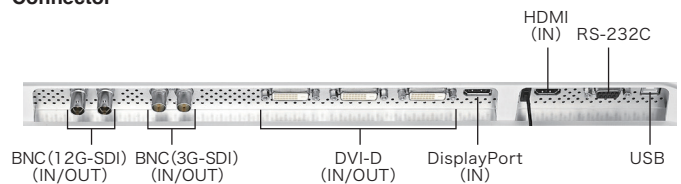

You will find your EIZO contact partner at:  
[www.eizo-or.com/contact](http://www.eizo-or.com/contact)

All product names are trademarks or registered trademarks of their respective companies. EIZO, the EIZO Logo, and CuratOR are registered trademarks of EIZO Corporation. Specifications are subject to change without notice.